

1 Thoroughly clean the window pane, frame and rubber seal.

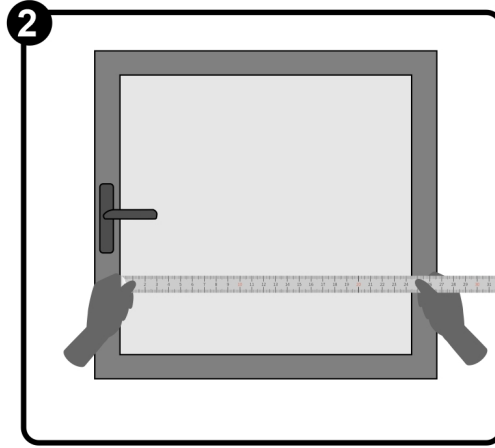

2 Measure the window area (only glass surface, without rubber seal).

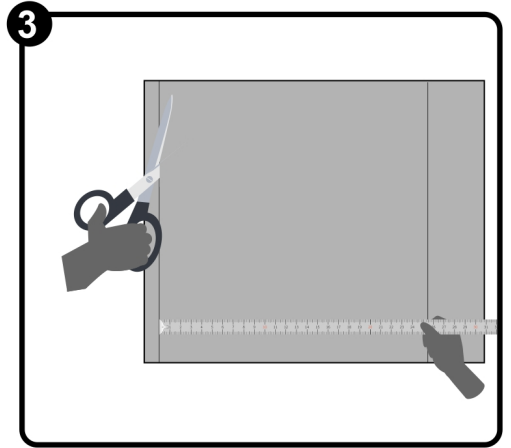

3 Transfer the dimensions to the carrier film and cut with scissors or a cutter.

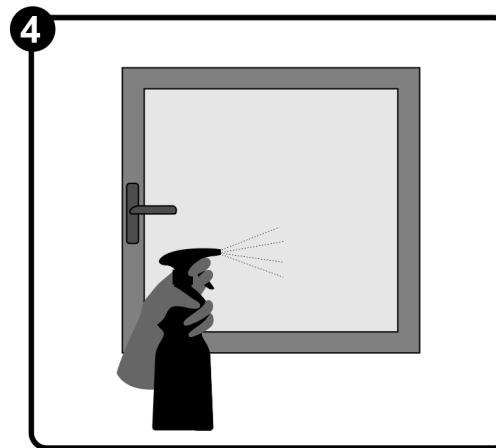

4 Wet the window glass well with a spray bottle filled with tap water and a squirt of dish soap.

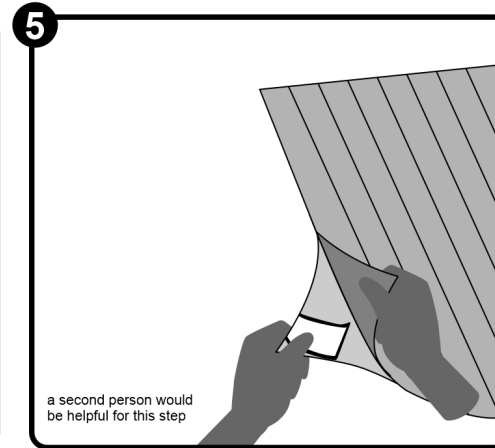

5 Wet your fingers with the prepared water from the spray bottle and peel off the backing film using the attached sticker. Also generously wet the adhesive side with the water-washing-up liquid mixture and attach to the pane.

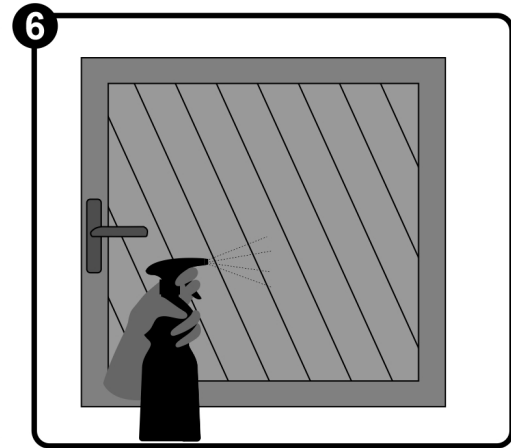

6 Spray the film again, align, press down with the squeegee and remove bubbles towards the edge (from top to bottom in the middle and to the sides first on the right then on the left, repeat several times)

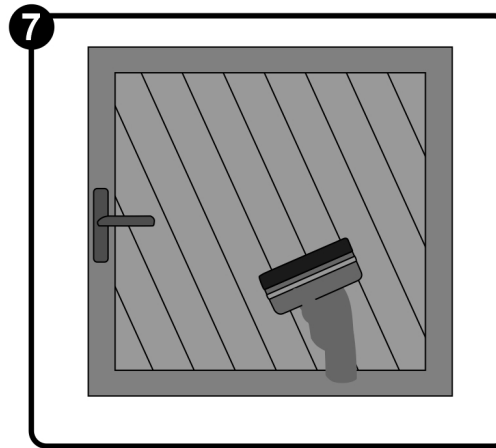

7 Carefully cut off the overhanging film at the edge with a cutter knife or film cutter so that the window or the rubber is not damaged.

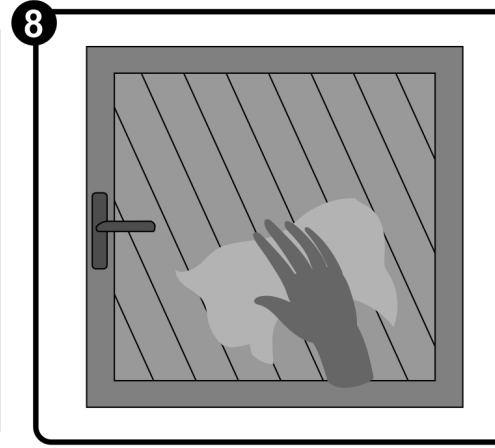

8 The moisture that has escaped can be dried at the edges with a cloth.

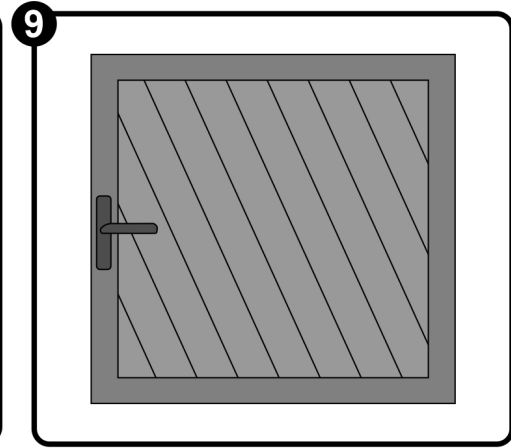

9 Allow the film to dry for 1-2 days and wait 1 week before cleaning the window in the usual way.